

Outdoor Directional 3-in-1 Cluster Antenna

MJS-ODV065R18J

X Pol, 65°

1710-2690MHz

17.2dBi, E-Tilt: 2-13

Electrical Specifications

Parameters / Specifications	Frequency Range (MHz)			
	1710-2690			
	1710-1880	1850-1990	1920-2170	2490-2690
Polarization	±45°			
Gain (dBi)	16.2	17.2	17.2	17.0
Horizontal Beamwidth (°)	65	63	62	60
Vertical Beamwidth (°)	7.2	7.0	6.6	5.6
Electrical Downtilt (°)	2-13			
1 st Upper Sidelobe Suppression (dB)	≥15(2°), ≥15(8°), ≥14(13°)			
Front-To-Back Ratio 180°±30° (dB)	≥ 25			
Cross-polar Discrimination @0° (dB)	≥17(typ.)			
VSWR	≤1.5:1			
Isolation between Ports (dB)	≥26			
IMD3 (2x43dBm Carrier) (dBc)	< -150			
Maximum Power Per Port (W)	250			
Impedance (Ω)	50			

Mechanical Specifications

Parameters	Specifications
Dimensions Diameter x Length (mm) / (in)	Antenna: Φ360x1850 / 14.2x72.8 Pedestal: Φ370x320 / 14.6x12.6
Weight (kg) / (lb)	Antenna: 48.0 / 106.7 Pedestal: 26.0 / 57.3
Radome Material and Color	UV Resistant PVC, White
Azimuth Adjustment per Sector	±20°
Azimuth Adjustment for Whole Antenna	±20°
Connector Type and Location	6 x 7/16 DIN-Female, Bottom
Operational Temperature (°C)	-40 to +60
Operational Humidity (%)	≤95
Operational/Max Wind Speed (km/h)	150 / 200
Shipping Dimensions, HxWxD (mm) / (in)	2015x470x470 / 79.3x18.5x18.5
Shipping Weight (kg) / (lb)	58.0 / 128.9
Lightning Protection	Direct Ground



Antenna without Pedestal

Note: The structure pedestal must be ordered separately

Pedestal and Mounting Details

00-MJS2-5122

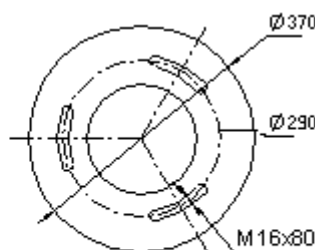
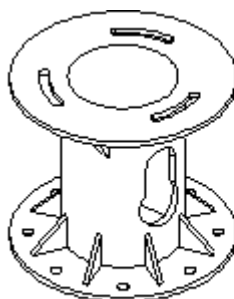

Top Flange

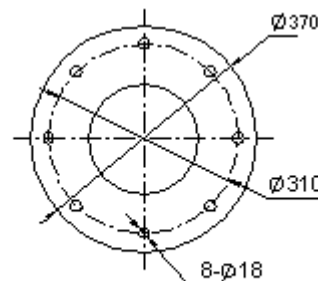

Bottom Flange